

December 17, 2004

Ms. Jenny Nusbaum
Department of Planning, Building Code & Enforcement
City of San Jose
801 North First Street, Room 400
San Jose, CA 95110

Re: Graniterock Conditional Use Permit Annual Report
City File No. CP00-03-009



Dear Jenny:

Condition 35 of the above referenced use permit requires that Graniterock submit an annual report documenting the status and results of the required mitigation.

Graniterock has been actively pursuing the required sub-permits for this project, and received approval to construct the outfall for the facility just prior to the end of the summer season. The outfall was installed, and a report outlining the project and mitigation efforts in this area is attached. No other work took place on the site in 2004.

In addition, more detailed drawings of the riparian revegetation plan and mitigation monitoring have been required by various agencies, so I have enclosed a complete set of the most recent plans for the site (these are all in conformance with the city approved site plans, just more detailed). For your convenience I have submitted one full size set and two reduced copies.

We are now in the process of obtaining the grading plan and final water district permit required to construct the project. We anticipate completing the riparian setback in January or February, and the remainder of the grading as the weather allows. The site will first be utilized for recycling road materials in early summer, when the construction season begins.

Please contact me if you need additional information (831) 768-2106. Thank you very much.

Sincerely,

GRANITE ROCK COMPANY
Benjamin J. Licari
Director of Government Affairs

- Monterey County
- San Benito County
- San Mateo County
- Santa Clara County
- Santa Cruz County
- Alameda County
- City and County of San Francisco

Material Supplier/ Engineering Contractor
License #22

San Jose Flea Market
Parking Lot

Plant List

Symbol	#	Plant Name
B	12	Box Elder (Acer Negundo)
CB	20	Blackberry (Rubus Ursinus)
CR	20	California Rose (Rosa Californica)
C	15	Cottonwood (Populus Fremontii)
E	12	Elderberry (Sambucus Mexicana)
W	14	Willow (Full Binomial of Native Willows)

GraniteRock
Asphalt Plant

San Jose
Water Company
Yard

Metal Recyclers

Pick n Pull Auto Dismantler

Parcel A
APN 241-05-014
1.70 Acres

Prepared By:
Thomas Field Associates
580 Waverley St., Suite 210
Palo Alto, Ca. 94301
(850) 327-0429
Christine Schneider, CA-LA #5261

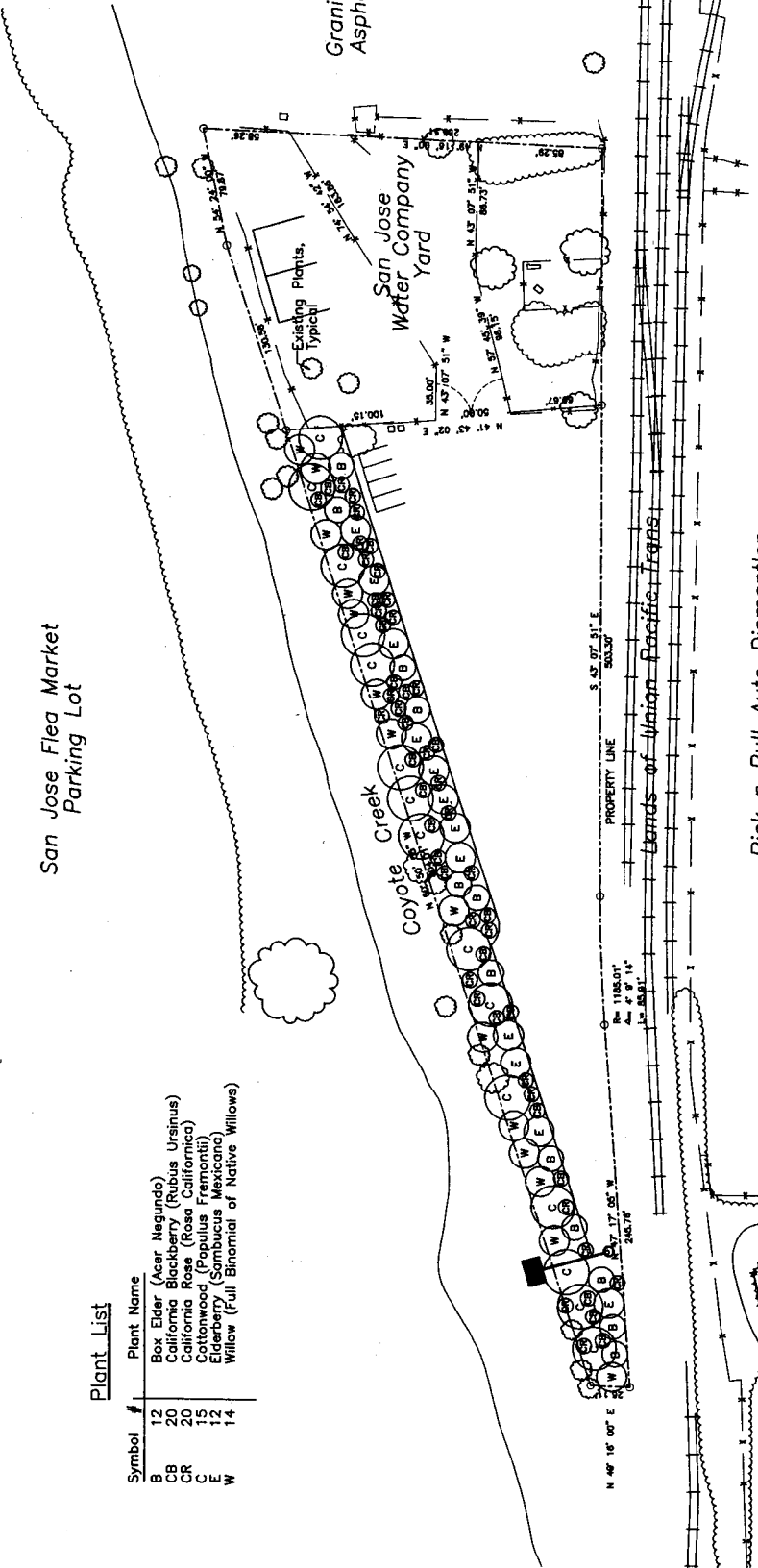

NO.	BY	DATE	REVISION
1	ME	5/14/02	CHANGED 25' OFFSET TO 30'
2	ME	9/28/04	CHANGED 30' OFFSET TO 30'AVE
3	ME	9/28/04	CHANGED 30' OFFSET TO 30'AVE
4	ME	9/28/04	CHANGED 30' OFFSET TO 30'AVE
5	ME	9/28/04	CHANGED 30' OFFSET TO 30'AVE
6	ME	9/28/04	CHANGED 30' OFFSET TO 30'AVE
7	ME	9/28/04	CHANGED 30' OFFSET TO 30'AVE
8	ME	9/28/04	CHANGED 30' OFFSET TO 30'AVE
9	ME	9/28/04	CHANGED 30' OFFSET TO 30'AVE
10	ME	9/28/04	CHANGED 30' OFFSET TO 30'AVE
11	ME	9/28/04	CHANGED 30' OFFSET TO 30'AVE
12	ME	9/28/04	CHANGED 30' OFFSET TO 30'AVE
13	ME	9/28/04	CHANGED 30' OFFSET TO 30'AVE
14	ME	9/28/04	CHANGED 30' OFFSET TO 30'AVE
15	ME	9/28/04	CHANGED 30' OFFSET TO 30'AVE
16	ME	9/28/04	CHANGED 30' OFFSET TO 30'AVE
17	ME	9/28/04	CHANGED 30' OFFSET TO 30'AVE
18	ME	9/28/04	CHANGED 30' OFFSET TO 30'AVE
19	ME	9/28/04	CHANGED 30' OFFSET TO 30'AVE
20	ME	9/28/04	CHANGED 30' OFFSET TO 30'AVE
21	ME	9/28/04	CHANGED 30' OFFSET TO 30'AVE
22	ME	9/28/04	CHANGED 30' OFFSET TO 30'AVE
23	ME	9/28/04	CHANGED 30' OFFSET TO 30'AVE
24	ME	9/28/04	CHANGED 30' OFFSET TO 30'AVE
25	ME	9/28/04	CHANGED 30' OFFSET TO 30'AVE
26	ME	9/28/04	CHANGED 30' OFFSET TO 30'AVE
27	ME	9/28/04	CHANGED 30' OFFSET TO 30'AVE
28	ME	9/28/04	CHANGED 30' OFFSET TO 30'AVE
29	ME	9/28/04	CHANGED 30' OFFSET TO 30'AVE
30	ME	9/28/04	CHANGED 30' OFFSET TO 30'AVE
31	ME	9/28/04	CHANGED 30' OFFSET TO 30'AVE
32	ME	9/28/04	CHANGED 30' OFFSET TO 30'AVE
33	ME	9/28/04	CHANGED 30' OFFSET TO 30'AVE
34	ME	9/28/04	CHANGED 30' OFFSET TO 30'AVE
35	ME	9/28/04	CHANGED 30' OFFSET TO 30'AVE
36	ME	9/28/04	CHANGED 30' OFFSET TO 30'AVE
37	ME	9/28/04	CHANGED 30' OFFSET TO 30'AVE
38	ME	9/28/04	CHANGED 30' OFFSET TO 30'AVE
39	ME	9/28/04	CHANGED 30' OFFSET TO 30'AVE
40	ME	9/28/04	CHANGED 30' OFFSET TO 30'AVE
41	ME	9/28/04	CHANGED 30' OFFSET TO 30'AVE
42	ME	9/28/04	CHANGED 30' OFFSET TO 30'AVE
43	ME	9/28/04	CHANGED 30' OFFSET TO 30'AVE
44	ME	9/28/04	CHANGED 30' OFFSET TO 30'AVE
45	ME	9/28/04	CHANGED 30' OFFSET TO 30'AVE
46	ME	9/28/04	CHANGED 30' OFFSET TO 30'AVE
47	ME	9/28/04	CHANGED 30' OFFSET TO 30'AVE
48	ME	9/28/04	CHANGED 30' OFFSET TO 30'AVE
49	ME	9/28/04	CHANGED 30' OFFSET TO 30'AVE
50	ME	9/28/04	CHANGED 30' OFFSET TO 30'AVE
51	ME	9/28/04	CHANGED 30' OFFSET TO 30'AVE
52	ME	9/28/04	CHANGED 30' OFFSET TO 30'AVE
53	ME	9/28/04	CHANGED 30' OFFSET TO 30'AVE
54	ME	9/28/04	CHANGED 30' OFFSET TO 30'AVE
55	ME	9/28/04	CHANGED 30' OFFSET TO 30'AVE
56	ME	9/28/04	CHANGED 30' OFFSET TO 30'AVE
57	ME	9/28/04	CHANGED 30' OFFSET TO 30'AVE
58	ME	9/28/04	CHANGED 30' OFFSET TO 30'AVE
59	ME	9/28/04	CHANGED 30' OFFSET TO 30'AVE
60	ME	9/28/04	CHANGED 30' OFFSET TO 30'AVE
61	ME	9/28/04	CHANGED 30' OFFSET TO 30'AVE
62	ME	9/28/04	CHANGED 30' OFFSET TO 30'AVE
63	ME	9/28/04	CHANGED 30' OFFSET TO 30'AVE
64	ME	9/28/04	CHANGED 30' OFFSET TO 30'AVE
65	ME	9/28/04	CHANGED 30' OFFSET TO 30'AVE
66	ME	9/28/04	CHANGED 30' OFFSET TO 30'AVE
67	ME	9/28/04	CHANGED 30' OFFSET TO 30'AVE
68	ME	9/28/04	CHANGED 30' OFFSET TO 30'AVE
69	ME	9/28/04	CHANGED 30' OFFSET TO 30'AVE
70	ME	9/28/04	CHANGED 30' OFFSET TO 30'AVE
71	ME	9/28/04	CHANGED 30' OFFSET TO 30'AVE
72	ME	9/28/04	CHANGED 30' OFFSET TO 30'AVE
73	ME	9/28/04	CHANGED 30' OFFSET TO 30'AVE
74	ME	9/28/04	CHANGED 30' OFFSET TO 30'AVE
75	ME	9/28/04	CHANGED 30' OFFSET TO 30'AVE
76	ME	9/28/04	CHANGED 30' OFFSET TO 30'AVE
77	ME	9/28/04	CHANGED 30' OFFSET TO 30'AVE
78	ME	9/28/04	CHANGED 30' OFFSET TO 30'AVE
79	ME	9/28/04	CHANGED 30' OFFSET TO 30'AVE
80	ME	9/28/04	CHANGED 30' OFFSET TO 30'AVE
81	ME	9/28/04	CHANGED 30' OFFSET TO 30'AVE
82	ME	9/28/04	CHANGED 30' OFFSET TO 30'AVE
83	ME	9/28/04	CHANGED 30' OFFSET TO 30'AVE
84	ME	9/28/04	CHANGED 30' OFFSET TO 30'AVE
85	ME	9/28/04	CHANGED 30' OFFSET TO 30'AVE
86	ME	9/28/04	CHANGED 30' OFFSET TO 30'AVE
87	ME	9/28/04	CHANGED 30' OFFSET TO 30'AVE
88	ME	9/28/04	CHANGED 30' OFFSET TO 30'AVE
89	ME	9/28/04	CHANGED 30' OFFSET TO 30'AVE
90	ME	9/28/04	CHANGED 30' OFFSET TO 30'AVE
91	ME	9/28/04	CHANGED 30' OFFSET TO 30'AVE
92	ME	9/28/04	CHANGED 30' OFFSET TO 30'AVE
93	ME	9/28/04	CHANGED 30' OFFSET TO 30'AVE
94	ME	9/28/04	CHANGED 30' OFFSET TO 30'AVE
95	ME	9/28/04	CHANGED 30' OFFSET TO 30'AVE
96	ME	9/28/04	CHANGED 30' OFFSET TO 30'AVE
97	ME	9/28/04	CHANGED 30' OFFSET TO 30'AVE
98	ME	9/28/04	CHANGED 30' OFFSET TO 30'AVE
99	ME	9/28/04	CHANGED 30' OFFSET TO 30'AVE
100	ME	9/28/04	CHANGED 30' OFFSET TO 30'AVE

GraniteRock
ALL Major Street
(831) 769-2262

DATE: 9/28/04
SCALE: 1"=40'

PROJECT: San Jose Road Materials
Berrysano Branch 221

PROJECT: Berrysano Road Materials Asphalt/Concrete
Recycle Center Conceptual Landscape Plan

DRAWING NO.: 2219901-104

NOTES FOR CONSTRUCTION OF OUTFALL

1. IT IS MANDATORY THAT THE SCWD INSPECTOR BE NOTIFIED AT LEAST 48 HOURS PRIOR TO THE COMMENCEMENT OF CONSTRUCTION. COMPLETE REMOVAL OF PORTIONS OF THE WORK INSTALLED WITHOUT INSPECTION MAY BE REQUIRED IF THIS REQUIREMENT IS NOT MET.
2. ALL WORK IS TO BE IN ACCORDANCE WITH THE STATE STANDARD SPECIFICATIONS SECTION 72-2. NO WHITE ROCK MAY BE USED. METHOD B PLACEMENT SHALL BE USED. GROUT TO BE IN CONFORMANCE WITH PARAGRAPH 65-1.06 FOR CEMENT MORTAR.
3. THE OUTFALL PIPE IS TO BE CUT OFF FLUSH WITH THE SLOPE PROTECTION.
4. ANY BACK FILL NECESSARY FOR THE INSTALLATION OF THE OUTFALL SHOULD BE COMPACTED TO 90 PERCENT RELATIVE COMPACTION IN CONFORMANCE WITH ASTM STANDARD TEST METHOD D1557.
5. ANY EXCESS SOIL FROM EXCAVATION SHALL BE DEPOSITED OFF OF THE DISTRICT RIGHT OF WAY UNLESS APPROVED BY THE DISTRICT'S INSPECTOR.

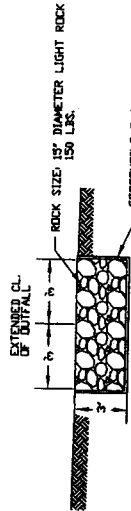

SECTION 'A'

TYPICAL CROSS SECTION OUTFALL

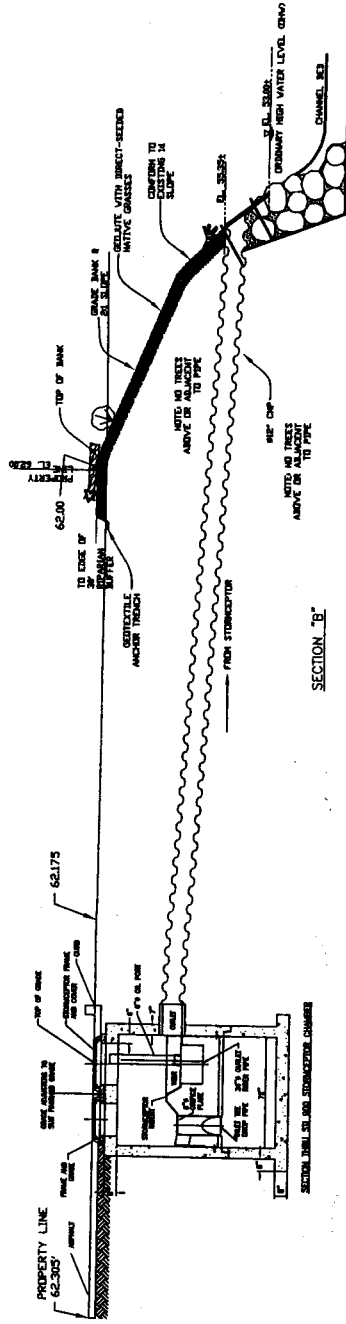

SECTION 'B'

NO.	DATE	REVISION
ME 3/29/01	ADDED SECTION A AND B	
ME 5/24/01	REVISED SECTION A AND B	
ME 5/24/01	CHANGED SACKS TO ROCKS	
ME 5/24/01	CHANGED SACKS TO ROCKS	

Granttrach
 411 West Street
 (831) 785-2000

DATE: 7-2-01
 DRAWN BY: M. Schumaker
 CHECKED BY: J. Park
 SCALE: 1"=40'

LOCATION:
 San Jose Road Materials
 Berryessa Branch 221

SUBJECT:
 Berryessa Road Materials Asphalt/Concrete
 Recycle Center Proposed Outfall Plan

DRAWING NO.
 22198P-01-108

