

# ROOSEVELT COMMUNITY CENTER

Winter registration begins December



Get out and play...everyday!

11 E. SANTA CLARA STREET

SAN JOSÉ, CA 95116

408.794.7555

[WWW.SANJOSECA.GOV/PPDS](http://WWW.SANJOSECA.GOV/PPDS)



Parks, Recreation and  
Neighborhood Services

### Early Childhood Recreation (ECR)



Please consider the following policies and requirements before registering for an Early Childhood Recreation (ECR) class offered by the City of San Jose.

Parents may volunteer during the session, depending on the amounts of meetings and the number of students. No siblings will be allowed and non-registered children are not allowed in the class at any time. Please make arrangements for siblings on your participation day. Each child must be the required age on the first day of class. A birth certificate may be requested for age confirmations. **Participants must be toilet trained by first day of program.**

Please Note: The City of San Jose, Department of Parks, Recreation and Neighborhood Services provide **recreational programs ONLY, and not licensed child-care.**

\*Teacher to child ratio is 1:10 for Kinder Ready and Phonics/Pre-Reading. After reaching the capacity your child can be put on a waitlist.

#### Kinder Ready

This class prepares your child for kindergarten with age-appropriate activities, learning concepts, socialization skills and fun. Your child learns alphabet sounds, shapes and colors. The goal is to have fun, participate and learn. Children must be potty trained by the first day of class. \*Parents are encouraged to volunteer and each child must bring a snacks.

| Course #   | Location  | Time     | Date      | Day | Ages | Instructor | Cost |
|------------|-----------|----------|-----------|-----|------|------------|------|
| 234.3.0301 | Roosevelt | 9am-12pm | 1/18-1/27 | MWF | 3-5  | Mrs. J.    | \$68 |
| 234.3.0302 | Roosevelt | 9am-12pm | 1/30-2/10 | MWF | 3-5  | Mrs. J.    | \$72 |
| 234.3.0303 | Roosevelt | 9am-12pm | 2/13-2/24 | MWF | 3-5  | Mrs. J.    | \$68 |
| 234.3.0304 | Roosevelt | 9am-12pm | 2/27-3/9  | MWF | 3-5  | Mrs. J.    | \$72 |
| 234.3.0305 | Roosevelt | 9am-12pm | 3/12-3/23 | MWF | 3-5  | Mrs. J.    | \$72 |

#### Phonics/Pre Reading

This new class consists of songs, writing, projects and stories. Kids will review letter sounds, learn simple word blending. This class is for children who know the majority of the alphabet and can write their name. Children must be potty trained by the first day of class. Parent participation varies at each center.

| Course #   | Location  | Time     | Date      | Day  | Ages | Instructor | Cost |
|------------|-----------|----------|-----------|------|------|------------|------|
| 234.3.0311 | Roosevelt | 9am-12pm | 1/17-1/26 | T/TH | 3-5  | Mrs. J.    | \$61 |
| 234.3.0312 | Roosevelt | 9am-12pm | 1/31-2/9  | T/TH | 3-5  | Mrs. J.    | \$61 |
| 234.3.0313 | Roosevelt | 9am-12pm | 2/14-2/23 | T/TH | 3-5  | Mrs. J.    | \$61 |
| 234.3.0314 | Roosevelt | 9am-12pm | 2/28-3/8  | T/TH | 3-5  | Mrs. J.    | \$61 |
| 234.3.0315 | Roosevelt | 9am-12pm | 3/13-3/22 | T/TH | 3-5  | Mrs. J.    | \$61 |

### Enrichment/Education

#### Spanish for Adults

Do you wish you could converse in Spanish at work, home, with friends or during your travels? This class will help you understand and speak Spanish in almost any situation. Vocabulary, grammar, and useful phrases will be taught by a native Spanish speaker. No previous knowledge of Spanish is required.



| Course #   | Location  | Time     | Date      | Day | Ages | Instructor | Cost |
|------------|-----------|----------|-----------|-----|------|------------|------|
| 234.3.0403 | Roosevelt | 6-6:45pm | 1/19-2/23 | TH  | 18+  | Staff      | \$50 |

#### Spanish for school-Age Children Level 1

It's never too early to educate your kids about another culture by learning the language. Your child will learn the basics of this amazing language through fun, hands-on activities, worksheets, songs, stories, projects and games. They will celebrate all that they have learned at the end of the session with a Fiesta!

| Course #   | Location  | Time       | Date     | Day | Ages | Instructor | Cost |
|------------|-----------|------------|----------|-----|------|------------|------|
| 234.3.0404 | Roosevelt | 10-10:45am | 1/21-3/3 | S   | 6-12 | Staff      | \$50 |

### Computer Basics

This computer class will get you through the basics on a PC computer. We will show you how to turn on your computer, use your mouse and navigate the internet. Once you are comfortable with your computer, we will show you how to create basic documents using Microsoft Word and Excel to name a few.

| Course #   | Location  | Time     | Date      | Day | Ages | Instructor | Cost |
|------------|-----------|----------|-----------|-----|------|------------|------|
| 234.3.0401 | Roosevelt | 5-5:45pm | 1/20-2/24 | F   | 16+  | Staff      | \$50 |

### Introduction to Google

Google is a powerful but simple Internet search engine that allows you to search billions of Web pages. This course gives you a thorough but concise tour of Google's features. If it's out there, you can find it. A comprehensive manual is included. Don't search, Google!

| Course #   | Location  | Time          | Date     | Day | Ages | Instructor | Cost |
|------------|-----------|---------------|----------|-----|------|------------|------|
| 234.3.0402 | Roosevelt | 10:10-10:55am | 1/21-3/3 | S   | 16+  | Staff      | \$50 |

### Music & Theatre

#### Guitar

This course will teach you how to improvise music on your guitar. You will learn to tune your guitar, use different patterns and chords from diagrams. You will learn to play along with most songs in any key, and play different strumming patterns. Bring your own guitar. All instructional material is provided.



| Course #   | Location  | Time          | Date      | Day | Ages | Instructor  | Cost |
|------------|-----------|---------------|-----------|-----|------|-------------|------|
| 234.3.0603 | Roosevelt | 5-6pm         | 1/19-2/23 | TH  | 7+   | Cordova, J. | \$69 |
| 234.3.0605 | Roosevelt | 10:10-11:10am | 1/21-3/3  | S   | 7+   | Cordova, J. | \$69 |

#### DRUMS 101



Have you ever wanted to learn how to drum but didn't know where to begin? This class will teach basic drum beats, introduction to music notes and develop coordination and rhythm, while having fun in a safe and learning environment.

| Course #   | Location  | Time        | Date      | Day | Ages | Instructor  | Cost |
|------------|-----------|-------------|-----------|-----|------|-------------|------|
| 234.3.0604 | Roosevelt | 6:15-7:15pm | 1/19-2/23 | TH  | 7+   | Cordova, J. | \$69 |
| 234.3.0606 | Roosevelt | 9-10am      | 1/21-3/3  | S   | 7+   | Cordova, J. | \$69 |

#### Music Together

Music Together® is a research-based, developmentally appropriate music and movement program for children and their caregivers. Classes are fun and informal. Songs, chants, instrumental play and dance are experienced in a non-performance, mixed-age, participation encouraged environment.

| Course #   | Location  | Time         | Date      | Day | Ages | Instructor        | Cost  |
|------------|-----------|--------------|-----------|-----|------|-------------------|-------|
| 234.3.0601 | Roosevelt | 9:30-10:15am | 1/23-3/26 | M   | 0-5  | Makers<br>Harmony | \$192 |

### Camp San José



#### Camp San José Presidents Week Camp



At Camp San José your child gets an unforgettable, traditional camp experience for under \$4 an hour! Your child will be playing crazy games, sports, creating cool arts & crafts projects, skill building, new friendships, disguised learning and much more. Our price includes a low leader to child ratio-10:1. Campers need to bring a lunch and water. For your convenience, Camp San José drop off starts at 8:00am. Extended care from 3:00-6:00pm is available for an additional cost.

| Course #   | Location  | Time    | Date      | Day | Ages | Instructor | Cost |
|------------|-----------|---------|-----------|-----|------|------------|------|
| 234.3.1001 | Roosevelt | 8am-3pm | 2/21-2/24 | T-F | 5-12 | Staff      | \$83 |
| 234.3.1011 | Roosevelt | 3-6pm   | 2/21-2/24 | T-F | 5-12 | Staff      | \$24 |

**Sports**

**Basketball Competitive Co-ed**

A NEW Competitive sports league designed for youths looking to play basketball. Teams will compete against each other to place 1st, 2nd, or 3rd with their own age groups. All participants will receive a T-shirt and award. Volunteer coaches are essential for a successful league. If interested in being a volunteer coach, please indicate on the registration form and include your T-Shirt size. The City of San José has a program through which potential volunteers with supervisory or disciplinary control over minors at recreation centers are fingerprinted. The fingerprints are then sent to the California Department of Justice and the Federal Bureau of Investigation for criminal background check.



| Course #   | Location  | Time  | Date      | Day | Ages | Instructor | Cost |
|------------|-----------|-------|-----------|-----|------|------------|------|
| 234.3.0901 | Roosevelt | 1-9pm | 1/28-3/31 | S   | 7-15 | Staff      | \$98 |

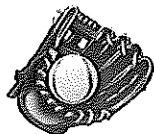

**Softball (Adults) Men, Women and Co-ed**

Adult softball leagues for men, women and coed in Competitive (high), Recreational A (intermediate) and Recreational B (low) levels are offered in the spring, summer and fall at locations throughout the City of San Jose. Team registration fee includes games, certified umpires, and scorekeepers. Top four teams

make playoffs. The maximum number of players allowed on the roster is 14. Games are scheduled Monday-Thursday at 6:30pm, 7:40pm, and 8:50pm.

| Course #   | Location  | Time                | Date    | Day  | Ages | Instructor | Cost           |
|------------|-----------|---------------------|---------|------|------|------------|----------------|
| 234.3.0900 | Roosevelt | 6:30, 7:40 & 8:50pm | 3/5-5/3 | M/W  | 18+  | Staff      | \$580 per team |
| 234.3.0901 | Columbus  | 6:30, 7:40 & 8:50pm | 3/5-5/3 | T/TH | 18+  | Staff      | \$580 per team |

**Therapeutic**

**Team Fitness**

What is your team waiting for? The time has come to jump start your fitness lifestyle. This program is located at the fully equipped Roosevelt Community Fitness Center, and ages 18 and up are welcome. Stay in shape using treadmills, exercise bikes, weight machines and much more. This class is especially designed for adult day programs, group homes and other organizations working with adults with cognitive disabilities. You will be guided through an individually tailored workout program specifically designed with your goals, abilities and priorities in mind. Staff from your agency/organization will accompany the group and our fitness staff will design individualized workout plans. Sign up and make an appointment for a series of four sessions or one workshop on your schedule.

**Urban Explorers**

Get out and explore! Did you know that there are twenty-four unique trail systems and over 50 miles of trails throughout San Jose? Some may already be in your neighborhood! This is a Saturday hike and walking club directed towards teens and young adults with disabilities. Each week, we will meet at the Roosevelt Community Center and travel using public transportation to different trails and walks in the area. San Jose has a lot to offer its urban dwelling explorers. We'll learn about our unique natural and cultural history while meeting new friends and getting a little exercise. Participants must be able to participate in a 5:1 ratio.



**Playcamp**

These day camps are designed for children with cognitive disabilities who need a higher level of staff assistance for participation including those with Autism Spectrum disorder... Staff ratio is approximately 1 to 2. Activities will include arts and crafts; games, circle time, a field trip and more. Food will be provided for all cooking projects. Children should bring a sack lunch to camp each day.

**Fun for All**

This class focuses on fun with music, games, arts and crafts, movement activities and a field trip. This play program is designed for children with developmental disabilities including those with Autism Spectrum Disorders. Food will be provided for all cooking projects. Children

**PLAY!**

| Course #   | Class           | Time           | Date      | Day   | Ages  | Location  | Cost  |
|------------|-----------------|----------------|-----------|-------|-------|-----------|-------|
| 234.3.4011 | Creative Social | 10-11am        | 1/23-2/14 | M & T | 18+   | Roosevelt | \$10  |
| 234.3.4001 | Fun for All     | 9:30am-12:30pm | 1/21-3/17 | Sa    | 3-11  | Roosevelt | \$105 |
| 234.3.4005 | Funtastic Youth | 9:30am-12:30pm | 1/21-3/17 | Sa    | 11-14 | Roosevelt | \$105 |
| 234.3.4007 | Team Fitness    | 10-11am        | 1/9-1/31  | M-F   | 14-65 | Roosevelt | \$20  |
| 234.3.4008 | Team Fitness    | 10-11am        | 2/1-2/29  | M-F   | 14-65 | Roosevelt | \$20  |
| 234.3.4009 | Team Fitness    | 10-11am        | 3/1-3/29  | M-F   | 14-65 | Roosevelt | \$20  |
| 234.3.4201 | Playcamp        | 9:30am-1:30pm  | 2/21-2/24 | T-F   | 5-11  | Roosevelt | \$85  |
| 234.3.4004 | Urban Explorers | 1:30-5:30pm    | 1/21-3/17 | Sa    | 15-45 | Roosevelt | \$80  |

**Seniors (Active Adults (50+))**

**Chinese Opera**

Join the Chinese Opera group that plays traditional Chinese string and percussion instruments, while providing a strong rhythmic accessory to the acting and singing of the Chinese culture. This group enjoys practicing and playing their instruments, theater plays and songs, while enhancing the artistic roots and history.

**Chinese Brush Painting**

The single most astonishing fact about Chinese brush painting; is that each brush stroke is a defining move that produces a portion of the painting that is neither improved upon nor corrected. The artist paints with rapid, mentally constructed strokes transporting a "mind image" on mulberry paper. Chinese brush painting is meant to be more than a representation of an object: it is also a symbolic expression.

**Mahjong**

Want learn a fun game and make new friends? Come join us for a game of Mah-jong. This game originated in China, commonly played by four players. Mahjong is a game of skill, strategy and a certain degree of chance.

**Social Dance**

Come and join us in a fun filled activity of dancing to a wide variety of music. You will enjoy socializing with old friends and make new friends. Plus it is a great way to stay fit and active, by developing flexibility, strength, endurance and sense of well-being.

| Course #   | Class                  | Time         | Date      | Day | Ages | Instructor | Cost |
|------------|------------------------|--------------|-----------|-----|------|------------|------|
| 234.3.2006 | Chinese Opera          | 9:30am-3pm   | 1/18-3/23 | WF  | 50+  | Staff      | \$1  |
| 234.3.2002 | Chinese Brush Painting | 9:30-11:30am | 1/24-3/20 | T   | 50+  | Staff      | \$1  |
| 234.3.2003 | Mah Jong               | 9am-3pm      | 1/17-3/23 | M-F | 50+  | Staff      | \$1  |
| 234.3.2004 | Social Dance           | 1-3pm        | 1/17-3/20 | M-F | 50+  | Staff      | \$1  |
| 234.3.2005 | Social Dance           | 12-2pm       | 1/21-3/24 | Sa  | 50+  | Staff      | \$1  |

**Health & Fitness**



New exercise room also offering fitness and health classes

**Roosevelt Community Center**

**Site Specific**

**City Wide Access**

|  |         |  |                  |
|--|---------|--|------------------|
| <b>Basic Monthly Pass, Adult</b>                       | \$24.99 | <b>Basic Monthly Pass, Adult</b>                       | \$31.99          |
| <b>Youth/Senior/Disabled</b>                           | \$19    | <b>Youth/Senior/Disabled</b>                           | \$26             |
| <i>*Access to fitness room &amp; drop-in gym only.</i> |         | <i>*Access to fitness room &amp; drop-in gym only.</i> |                  |
| <b>Basic Annual</b>                                    | \$120   | <b>Basic Annual</b>                                    | \$149            |
| <i>Promotional Price (Ends 1/31/12)</i>                |         | <i>Promotional Price (Ends 1/31/12)</i>                |                  |
| <b>Monthly Pass with "Group X"</b>                     | \$29    | <b>"Group X" Monthly</b>                               | \$39             |
| <i>*Access to fitness room &amp; "Group X" Classes</i> |         | <i>*Access to fitness room &amp; "Group X" Classes</i> |                  |
| <i>*Excludes Mayfair Community Center</i>              |         | <i>*Excludes Mayfair Community Center</i>              |                  |
| <b>"Group X" Annual</b>                                | \$199   | <b>"Group X" Annual</b>                                | \$199+\$10 month |
| <i>*Access to fitness room &amp; "Group X" Classes</i> |         | <i>*Promotional Price (Ends 1/31/12)</i>               |                  |
| <i>*Promotional Price (Ends 1/31/12)</i>               |         | <i>*\$10 per month must be "auto pay"</i>              |                  |
| <b>"Group X" Class Drop-In</b>                         | \$10    |  |                  |
| <b>Adult 1 Day Drop-In</b>                             | \$5     |  |                  |
| <b>Youth/Senior/ Disabled</b>                          | \$2.50  |  |                  |

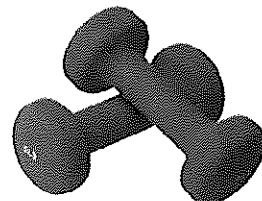

**Hours of Operation**

|                 |               |
|-----------------|---------------|
| Monday—Thursday | 6:00am—8:00pm |
| Friday          | 6:00am—6:00pm |
| Saturday        | 9:00am—1:00pm |

**Refund Policy**

There will be a \$10 processing fee for EACH activity. It may not be possible to refund the class materials charged by the instructor. Refund requests need to be made in writing and submitted to any PRNS facility 14 calendars days prior to the start of class or by email to [SJregistr@sanjoseca.gov](mailto:SJregistr@sanjoseca.gov).

**Seasonal Sports**

**Indoor Soccer**

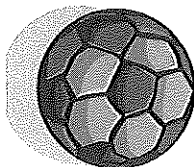

Competitive drop-in games for teams and individuals who like to play soccer for the love of it. Our indoor rink is unique and offers players a nice smooth surface to play safe and fun soccer. We offer indoor soccer for all age groups from 5 years old to adults, during the times of 4pm to 8pm during the week, Monday through Friday. The rink has an indoor surface but is located outdoors. We are closed on rainy days.

**Children Ages 5-12yrs. Team and Adults**

Monday—Friday 4-6pm Monday—Friday 6-8pm

(Times and Days change is determined by number of participants and weather.)

**Hockey (Begins SPRING)**

Roosevelt Roller Hockey Rink is a 180x80 hockey rink in downtown San Jose with Mateflex tiles (during summer) and Border Patrol Dasher Boards. The rink is open seasonally from March-November offering youth and adult hockey leagues, youth summer hockey camps, instruction, and pick-up hockey. All skill levels are welcome and all necessary equipment to play is available for rent.



**Pick-up Games**

Wednesday & Friday  
3-5pm—Youth 8-15 yrs. old  
5-6pm—Adults 16+

**Leagues**

Saturday  
9am-5pm—6-13 yrs. old  
Practice: Tuesday & Thursday

(Times and Days change is determined by number of participants and weather.)

**Teens**

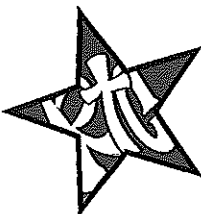

Does your teen need help with school work? Do they just want to go somewhere where they can play video games, play ping-pong, or just hang out with friends? Roosevelt Teen Center offers teens 12-17 various recreational activities along with homework help Monday through Friday from 3:00-7:00. The teen center works closely with surrounding schools to ensure that members have access to



quality programs that meets their educational goals and needs.

**Activities**

Homework center, computers, ping pong, billiards (pool table), video games (PS3, Wii, Xbox 360), sport leagues, movie nights, fitness room, field trips, community center hours, BBQ, job fairs and special events.

**Please call 408-794-7549 for more information.**

**Roosevelt Staff**



- Kendra Yarn—Supervisor
- Darren Tan—Therapeutics
- Stella Gutierrez—Senior Nutrition
- Viet Nguyen—Hockey Rink & Teen program
- Teresa Guillen—Drop-in Soccer and Leisure Classes
- Avan Duong—Fitness Center
- Vanessa Rosillo—Rental Coordinator
- Stephanie Habian—Customer Service
- Desiree Reyes—Customer Service
- Amanda Carrera—Teen Center
- Josh Orcine—Teen Center
- Jezebel Barraza—Kinder Tot Teacher
- John Cordova—Guitar and Drum Teacher
- Hugo Cervantes—Drop-in Soccer
- Yair Espino—Drop-in Soccer



**Rental Information**

**Community Room**

Capacity: Up to 294 people (seated dining)  
Up to 345 people (assembly seating)  
Fee: \$125 an hour—Residents  
\$150 an hour—Non Residents

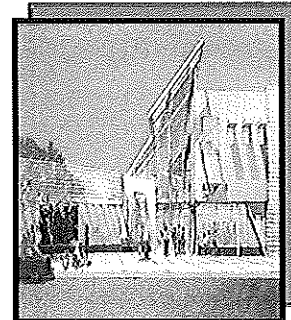

**Single Classroom 1 or 2**

Capacity: Up to 37 to 49 people  
Fee: \$40 an hour—Residents  
\$50 an hour—Non Residents

**Both Classrooms 1 & 2**

Capacity: Up to 74 to 98 people  
Fee: \$70 an hour—Residents  
\$100 an hour—Non Residents

**Cleaning/Damage Deposit \$500**

This cleaning/damage deposit is required at all events at the Roosevelt Community Center. This deposit is refundable if everything is properly cleaned, if the building is vacated at the designated time on application and if there are no damages to the prosperity. NOTE: Groups that intend to serve alcohol will pay an additional deposit of \$500 per application.

**Staff Cost**

**\$19 per hour**

All rentals require a minimum of one (1) staff member.

**Security**

**\$46.50 per officer**

A minimum of one (1) San José Police Officer is required at all events at the Roosevelt Community Center. The number of officers required depends upon the number of participants and type of event. Our staff will schedule the officer for the event. You, the renter, is responsible for direct payment within the first hour of your event with cash, money order or cashiers check.



**Important Notes**

- The facility is available for rent until 10:00pm.
- Smoking is prohibited inside the facility.
- You may reserve the facility on Saturdays from 3-10pm. Sundays is all day, if not reserved already.
- No rentals on holiday weekends.
- Consumption of alcoholic beverages by anyone under 21 years of age is strictly PROHIBITED!
- Alcohol beverages may not be sold!

**Amenities**

- Podium \$10
- Portable PA System \$30
- TV & VCR/DVD on cart \$25
- Built-in Movie Screen \$10
- Built-in LCD projector \$15
- Built-in Sound System \$25
- LCD projector \$25



**CANCELLATION CHARGES:**

*From the date of your event*  
**(90)DAYS OR MORE — \$50.00**  
**(30)DAYS OR MORE — 25% OF FEES**  
**LESS THAN (30) DAYS — 50% OF FEES**  
**No refund if less than 48 hours notice**