

SITE PLAN REQUIREMENTS

The purpose of a site plan is to clearly show where an existing house is on a property and where a proposed addition is going to be built. The setbacks (the distance between buildings and property lines) are to be labeled. The site plan, drawn to scale, should indicate the nature and scope of work.

EXAMPLE:

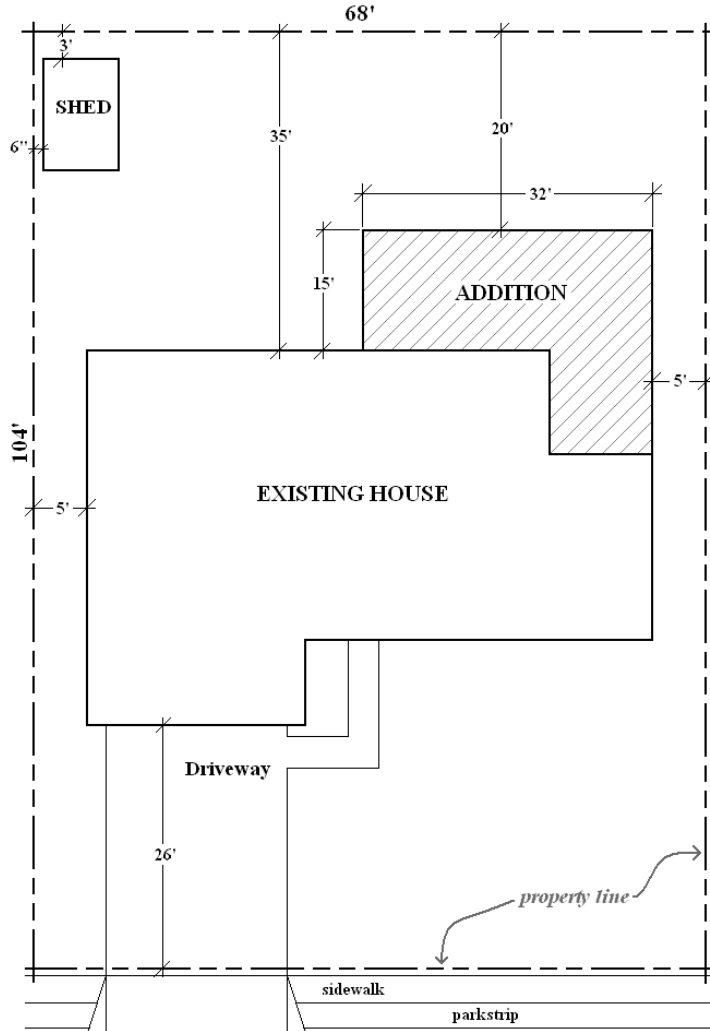

SITE AND BUILDING INFORMATION

- ADDRESS: 1234 Main Street
- ZONING: R - 1 - 8
- APN: 234 - 56 - 789
- LOT SIZE: 7,072 square feet
- EXISTING LIVING AREA: 1,600 square feet
- EXISTING GARAGE: 400 square feet
- PROPOSED ADDITION: 500 square feet
- PROPOSED TOTAL AREA: 2,100 square feet
- FLOOR AREA RATIO: 29.7%
- SCOPE OF WORK:
Family room addition, bedroom extension, new master bathroom and kitchen remodel.



Main Street