



DEPARTMENT OF PUBLIC WORKS
SAN JOSE, CALIFORNIA
City Facilities Architectural Services Division

PROJECT NO. 15050000
DRAWING NO. 15050000-003
DATE: 03/31/07
BY: KATY ALLEN
CHECKED: JEFFREY L. BROWN

SCALE: AS SHOWN
DATE: 03/31/07
BY: JEFFREY L. BROWN
CHECKED: KATY ALLEN

SCALE: AS SHOWN
DATE: 03/31/07
BY: JEFFREY L. BROWN
CHECKED: KATY ALLEN

SCALE: AS SHOWN
DATE: 03/31/07
BY: JEFFREY L. BROWN
CHECKED: KATY ALLEN

SCALE: AS SHOWN
DATE: 03/31/07
BY: JEFFREY L. BROWN
CHECKED: KATY ALLEN

WORK SHOWN ON THE PLAN AND PROFILE VIEWS ON THIS DRAWING IS NIC

TRAIL SIGNS & PAVEMENT MARKINGS KEY

REFER TO DRAWING C-13 FOR SIGNS WITH CUSTOM OR SPECIAL LETTERING/ARTWORK. SEE DET. 4, DWG. C-10 FOR SIGN NO. 6. QUANTITY IS FOR SIGNS INCLUDED IN THIS CONTRACT.

CONTRACTOR TO SUPPLY AND INSTALL SIGNS, POSTS AND FOOTINGS LOCATED ON THE TRAIL. CONTRACTOR SHALL VERIFY QUANTITY PRIOR TO ORDERING.

Sign No	Quant	Description & "Legend"
1	1	Bronze sign: "Los Gatos Creek Trail"
2	1	Grant Funding Sign
3	4	Trail Rules and Regulations Sign
4	4	R1 & special SW1: 18" Stop Sign & "Cross traffic does not stop"
5	4	White stop bar & "Stop" on asphalt
6	4	Special R1 & special G7-1: 18" Stop Ahead for Traffic & Street Name Sign
7	1	Dog Ordinance Sign - Supplied by City Pins
8	3	G93 & G32: "Bike Route" & Two-Directional Arrow Sign
9	2	"Downhill - Reduce Speed Ahead" & W1-4 L or R as appropriate
10	2	"Walk Bike on Bridge"
11	2	"Way 280 Undercrossing" & "Do not use Undercrossing prior to or immediately after any storm activity"
12	1	Special G8-7 Directional Sign: "Lincoln Avenue/Downtown" with Directional Arrows
13	5	Colored Concrete Awareness Strip
14	1	"Revegetation in Progress"
15	2	"Caution: Maintenance Vehicular Traffic Ahead"

CITY TO SUPPLY, INSTALL SIGNS, POLES, AND FOOTINGS LOCATED ON-STREET. CONTACT DEPARTMENT OF TRANSPORTATION, GEOMETRIC DESIGN SECTION AT (408) 535-3850 TWO WEEKS PRIOR TO WORK AREA BEING READY FOR THEIR INSTALLATION.

Sign No	Quant	Description & "Legend"
5	4	R44A (Ca): Bike Path/No Motor Vehicles or Motorized Bicycles
10	3	CSJ Special Design Guide Sign: "Los Gatos Creek Trail"
11	0	W11-2 & W16-7P: Pedestrian Crossing & Arrow Pointed Downward at Crosswalk
12	0	White Crosswalk
13	0	CSJ Special Design Guide Sign & G93: "To Los Gatos Creek Trail" & Bike Route Sign
14	2	CSJ Special Design Guide Sign & G93: "To Los Gatos Creek Trail" & Bike Route Sign
NA	3	R26 or R28 "No Parking Any Time". Sign locations on Home Street are at the discretion of the City.

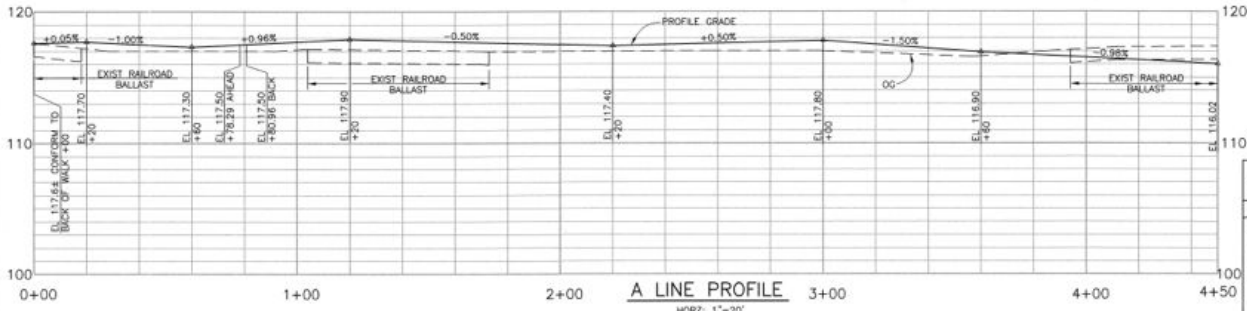

A LINE PROFILE
HORIZ. 1"=20'
VERT. 1"=4'

PLAN AND PROFILE NOTES, CONTINUED FROM DWG. G-1:

- 7. FOR PIPE BEDDING AND BACKFILL, SEE DRAWING C-9.
- 8. FOR NEW STORM INLET DETAILS, SEE DRAWING C-9.
- 9. FOR A.C. TRAIL STRUCTURAL SECTIONS, SEE DRAWING C-8.
- 10. FOR REMOVABLE BOLLARD DETAIL, SEE DRAWING C-10.
- 11. FOR OUTFALL PROFILES AND DETAILS, SEE DRAWINGS C-10 AND C-15.
- 12. THE EMERGENCY CALL BOX SYSTEM AND A 4'x4' PEDESTRIAN PAD WILL BE PROCURED AND INSTALLED BY THE CITY. THE CALL BOX SHALL BE PLACED A MINIMUM OF 2' FROM THE EDGE OF THE TRAIL UNDER THE DIRECTION OF THE INSPECTOR. THE CONTRACTOR SHALL CONTACT THE TRAILS PROGRAM MANAGER YVES ZSUTTY (408-793-5561), AND GEORGE SALCIDO, DEPARTMENT OF INFORMATION TECHNOLOGY (408-793-6886), WITH A 30 DAY ADVANCE NOTICE TO ARRANGE FOR INSTALLATION. INSTALLATION OF THE CALL BOX SYSTEM SHALL BE PRIOR TO THE END OF CONSTRUCTION. THE CITY WILL COORDINATE THE CALL BOX IDENTIFICATION INFORMATION WITH THE SJPD AND ARRANGE ACTIVATION WITH DENBRIDGE DIGITAL. SEE DETAIL 6, DRAWING C-13.
- 13. a. PROVIDE 4" YELLOW STRIPE (S' DASH WITH 9' BREAKS) ALONG CENTERLINE OF AC TRAILS.
b. 4" WHITE CONTINUOUS STRIPE, 1' FROM WALL, CURBS AND ADJACENT FENCES.
- 14. FOR EXISTING CONDITIONS AND DEMOLITION NOTES SEE DRAWING G-1.
- 15. REMOVE EXISTING RAILROAD BALLAST AND REPLACE WITH EARTH (NIC).
- 16. F-1, F-2, F-3 ETC., DENOTE LOCATIONS OF FITNESS COURSE STATIONS. SEE DWG. C-14.

DEMOLITION SCHEDULE DWG C-1

1	4" DIA POLE
2	WOOD FENCE
3	WOOD FENCE
4	TRACK BALLAST

CONTROL POINT TABLE

DWG	POINT NO.	OFFSET	STATION	N	E	ELEV.
C-1	1/2" IP	20.93' RT	A 0+38.29	10986.45	8358.06	116.83
C-1	29.8' SPIKE	35.69' RT	A 3+56.00	11219.35	8172.84	115.76
C-2	1/2" IP	3.41' RT	A 4+64.44	11324.07	8087.74	117.41
C-2	28.8' SPIKE	8.07' LT	A 5+52.62	11366.05	8023.97	116.78
C-2	26.8' SPIKE	17.40' RT	A 8+18.11	11562.86	7898.78	113.66
C-3	1/2" IP	87.26' LT	A 10+67.15	11817.25	7895.60	113.09
C-3	1/2" IP	10.35' RT	A 11+55.42	11850.32	8036.34	111.24
C-5	1/2" IP	18.60' RT	A 22+24.86	12827.95	8337.67	95.11
C-5	1/2" IP	6.55' RT	A 23+70.59	12918.63	8243.28	94.04
C-5	39. REBAR	43.47' LT	A 24+16.52	12888.86	8180.52	101.59
C-6	40. REBAR	15.12' RT	A 26+53.83	13117.29	8057.82	101.59
C-7	43. 1" HEX BOLT	33.24' RT	A 31+49.87	13509.19	7967.81	103.81
C-7	46. 1" HEX BOLT	62.92' RT	A 34+76.92	13733.42	8210.60	86.54
C-7	14. CHSLED X	NA	NA	13792.10	8232.91	101.60

TANGENT TABLE

LINE	LENGTH	BEARING
L1	6.19'	N20°59'22"W

CURVE TABLE

CURVE	RADIUS	LENGTH	DELTA	TANGENT
C1	160.00'	81.97'	29°21'18"	41.91'
C2	200.00'	190.56'	54°35'31"	103.21'
C3	240.00'	92.92'	22°10'55"	47.05'
C33	25.00'	8.42'	19°17'44"	4.25'
C34	38.00'	39.08'	58°50'23"	21.47'
C35	26.00'	27.87'	60°05'40"	15.94'

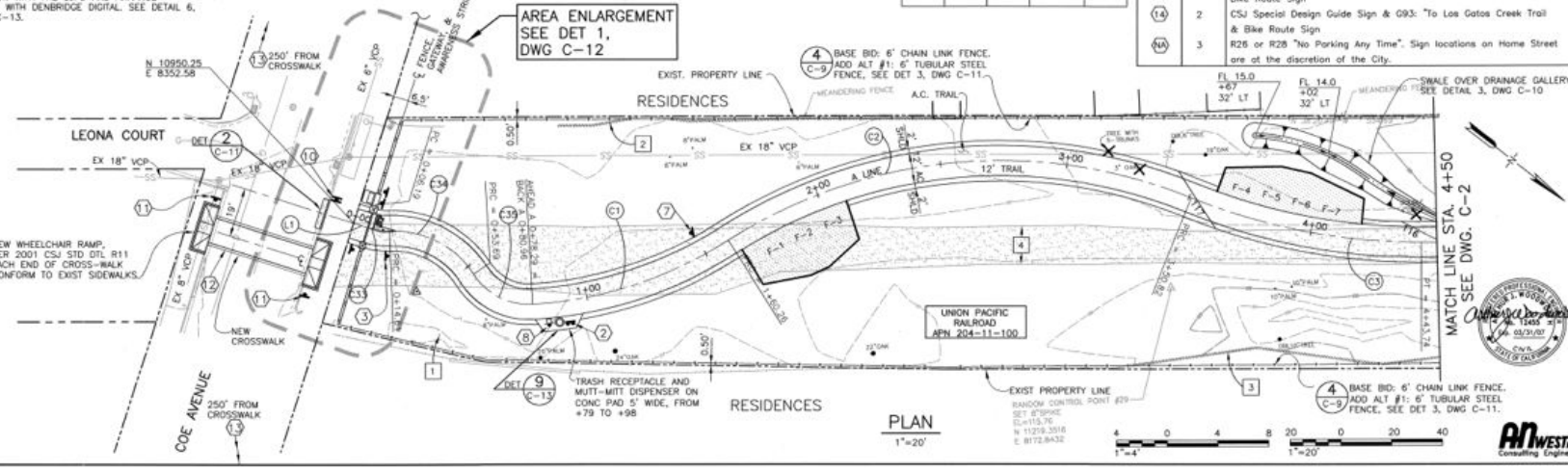

PROJECT NO. 15050000 DATE: 03/31/07 DWG. NO. 15050000-003



ANWEST
Consulting Engineers