

GREEN GARDENS
HEALTHY CREEKS

Nature's Inspiration Gardens

Guadalupe Courtyard
Garden Park, San José

Enjoy a self-guided tour and learn about how you can easily create a sustainable landscape in your own yard.

These two gardens showcase the basic principles of sustainable home landscaping. The gardens are designed to help you envision how you might apply these principles in your own yard.

The tour starts at Sign #1 to your right. Envision that you are entering the front yard of a home at the place marked with this arrow  on the map. As you proceed, you will encounter meandering pathways that culminate in a rectangular area that represents a patio.

Fact sheets on sustainable landscaping and design concept sheets that show ideas for various sizes and shapes of yards, are available for you to take home. You can find these at the Guadalupe River Park Conservancy Visitor Center at 438 Coleman Avenue, San José.

To learn more on this project, visit www.sanjoseca.gov/esd/stormwater/pesticides.asp

Directions

From Highway 87 exit southwest on West Taylor Street toward Coleman Avenue. Turn left onto Walnut Street and then turn left into the Seymour Street parking lot.



Working together for the greener good



Funding for this project has been provided in full or in part through a grant awarded by the Department of Pesticide Regulation (DPR). The contents of this document do not necessarily reflect the views and policies of the Department of Pesticide Regulation, nor does mention of trade names or commercial products constitute endorsement or recommendation for use.

Acknowledgement of support

- Santa Clara Valley Water District's Landscape Rebate Program
- Zanker Recycling for providing recycled mulch
- Pacific Interlocking for providing permeable pavers

In accordance with the Americans with Disabilities Act, City of San José Environmental Services Department materials can be made available upon request in alternative formats, such as Braille, large print, audiotape or computer disk. Requests may be made by calling (408) 945-3000 (Voice) or (800) 735-2929 (CRS).

 Printed on recycled paper. 1212/Q300/JY

Self-Guided Tour



© 2003 Christopher L. Christie

Nature's Inspiration Gardens

1 Cardboard Works as a Weed Barrier

A layer of cardboard is used underneath the mulch to prevent weeds. Learn more about sheet mulching here.

2 Mulch Recreates the Forest Floor

The soil is covered with a 3-inch mulch layer. Learn more about mulches here.

3 Slow the Flow of Rainwater

Permeable hardscape surfaces in these pathways allow rainwater to trickle through and soak into the soil. Learn about permeable pavers here.

4 Healthy Soil Makes Healthy Plants

Healthy soil creates healthy plants that are able to fight off weeds and diseases better. Learn how to make healthy soil here.

5 Nourishment Comes Naturally

Avoid routine fertilizing with fast-acting synthetic fertilizers as these have many negative consequences. Learn more here.

6 Right Plant in the Right Place

The plants in these gardens are deliberately spaced away from each other. Learn the importance of plant spacing here.

7 This Watering System Delivers

Sprinklers were replaced with a drip irrigation system in these gardens. Learn how drip irrigation can contribute to plant health here.

8 Connect to the Ecosystem with Native Plants

All plants selected for these gardens are native to California. Learn the reasons for selecting California native plants here.

9 What was Here Before?

A resource-draining Kentucky Bluegrass lawn was replaced by these beautiful gardens. Learn more here.

10 Being Bugged in the Garden?

These gardens provide a welcoming home to hummingbirds, bees, butterflies and other beneficial bugs. Learn why wildlife and beneficial bugs have a place in your garden.

Café Garden

Co-designed by Kim Leichner
Sustainable Landscape Design, San José

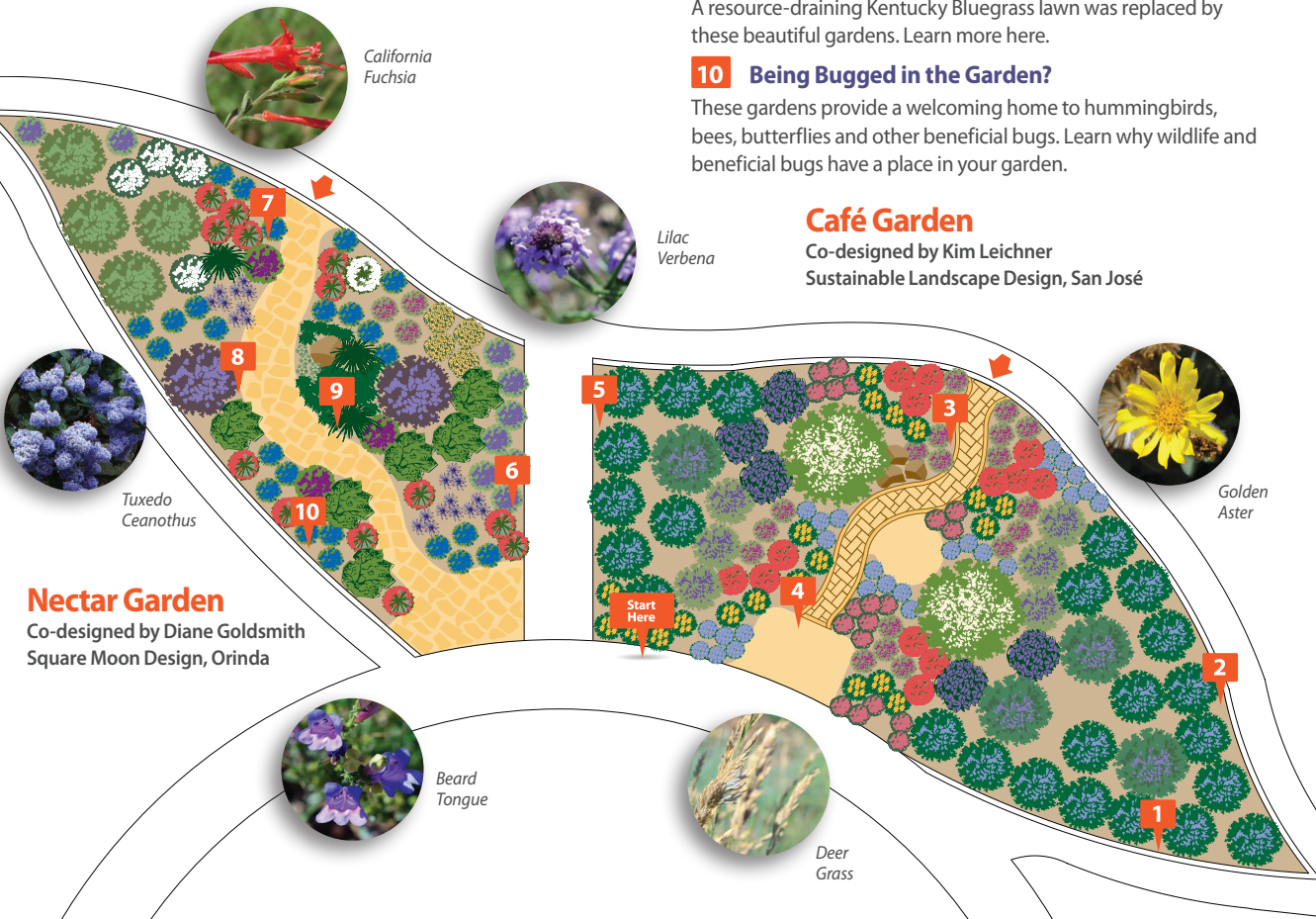

Nectar Garden

Co-designed by Diane Goldsmith
Square Moon Design, Orinda

Nectar Garden Plant List

Symbol	Botanical Name	Common Name
	<i>Arctostaphylos edmundsii parvifolium</i>	Pacific Mist Manzanita
	<i>Ceanothus x 'Tuxedo'</i>	Tuxedo Ceanothus
	<i>Rhamnus californica 'Mound San Bruno'</i>	Coffeeberry
	<i>Eriogonum fasciculatum</i>	California Buckwheat
	<i>Epilobium canum 'Cloverdale'</i>	California Fuchsia
	<i>Penstemon heterophyllus 'Blue Springs'</i>	Beard Tongue
	<i>Salvia sonomensis</i>	Creeping Sage
	<i>Mimulus 'Eleanor'</i>	Sticky Monkeyflower
	<i>Muhlenbergia rigens</i>	Deer Grass
	<i>Iris munzii</i>	Tulare Lavender Iris
	<i>Verbena lilicina</i>	Lilac Verbena
	<i>Eriogonum giganteum</i>	St. Catherine's Lace
	<i>Penstemon heterophyllus 'Margarita Bop'</i>	Beard Tongue
	<i>Dudleya pulverulenta</i>	Dudleya
	<i>Festuca idahoensis</i>	Idaho Fescue

Café Garden Plant List

Symbol	Botanical Name	Common Name
	<i>Ceanothus thyrsiflorus 'Snow Flurry'</i>	Wild Lilac
	<i>Ceanothus gloriosus 'Anchor Bay'</i>	Point Reyes Ceanothus
	<i>Ceanothus thyrsiflorus 'Skylark'</i>	California Lilac
	<i>Salvia clevelandii</i>	Cleveland Sage
	<i>Salvia leucophylla</i>	Purple Sage
	<i>Epilobium canum canum</i>	California Fuchsia
	<i>Penstemon heterophyllus 'Margarita Bop'</i>	Beard Tongue
	<i>Heterotheca villosa</i>	Golden Aster
	<i>Erigeron glaucas 'Wayne Roderick'</i>	Seaside Daisy
	<i>Eriogonum grande var. rubescens</i>	Rosy Buckwheat