

REFERENCE NUMBER	APN
1	575-02-022
2	575-02-023
3	575-02-024
4	575-02-025
5	575-02-026
6	575-02-027

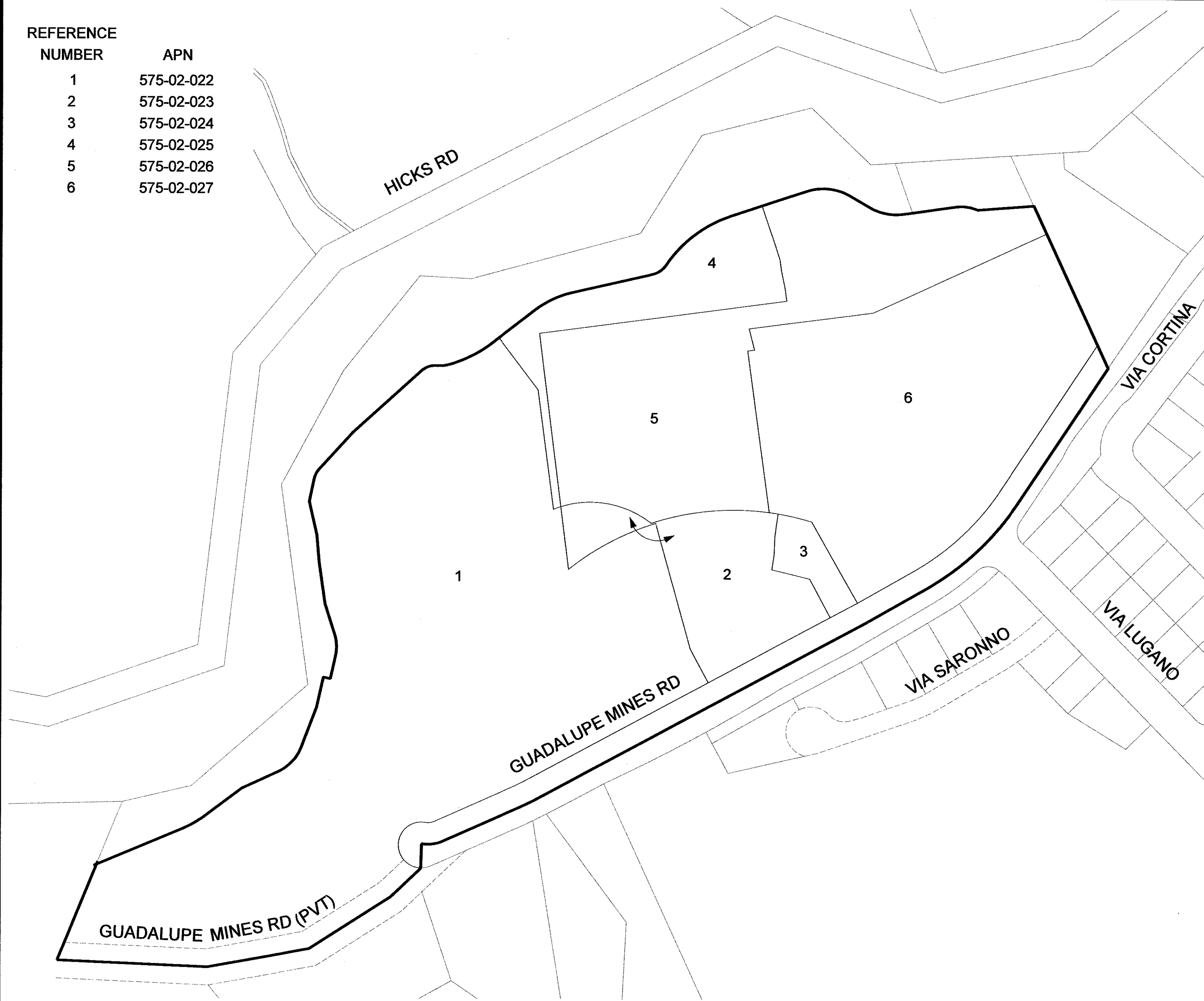

CERTIFICATIONS

(1) CITY CLERK

FILED IN THE OFFICE OF THE CITY CLERK OF THE CITY OF SAN JOSE THIS 9th DAY OF August 2012.

Dennis D. Hawkins
DENNIS D. HAWKINS, CMC
CITY CLERK

(2) CITY COUNCIL

I HEREBY CERTIFY THAT THE WITHIN MAP SHOWING THE PROPOSED BOUNDARIES OF COMMUNITY FACILITIES DISTRICT NO. 13 (GUADALUPE MINES), CITY OF SAN JOSE, COUNTY OF SANTA CLARA, STATE OF CALIFORNIA, WAS APPROVED BY THE CITY COUNCIL OF SAN JOSE AT A REGULAR MEETING THEREOF, HELD ON THE 14th DAY OF August 2012 BY ITS RESOLUTION NO. 712388.

Dennis D. Hawkins
DENNIS D. HAWKINS, CMC
CITY CLERK

(3) COUNTY RECORDER

FILED THIS 13th DAY OF September, 2012, AT THE HOUR OF 1:05 O'CLOCK P. M. IN BOOK 47 OF MAPS OF ASSESSMENT AND COMMUNITY FACILITIES DISTRICTS AT PAGE(S) 38, IN THE OFFICE OF THE COUNTY RECORDER OF THE COUNTY OF SANTA CLARA, STATE OF CALIFORNIA.
RECORDER'S SERIES NO.: 21851482 FEE PAID: \$8.-

Regina Alcomendras
REGINA ALCOMENDRAS, COUNTY RECORDER
COUNTY OF SANTA CLARA

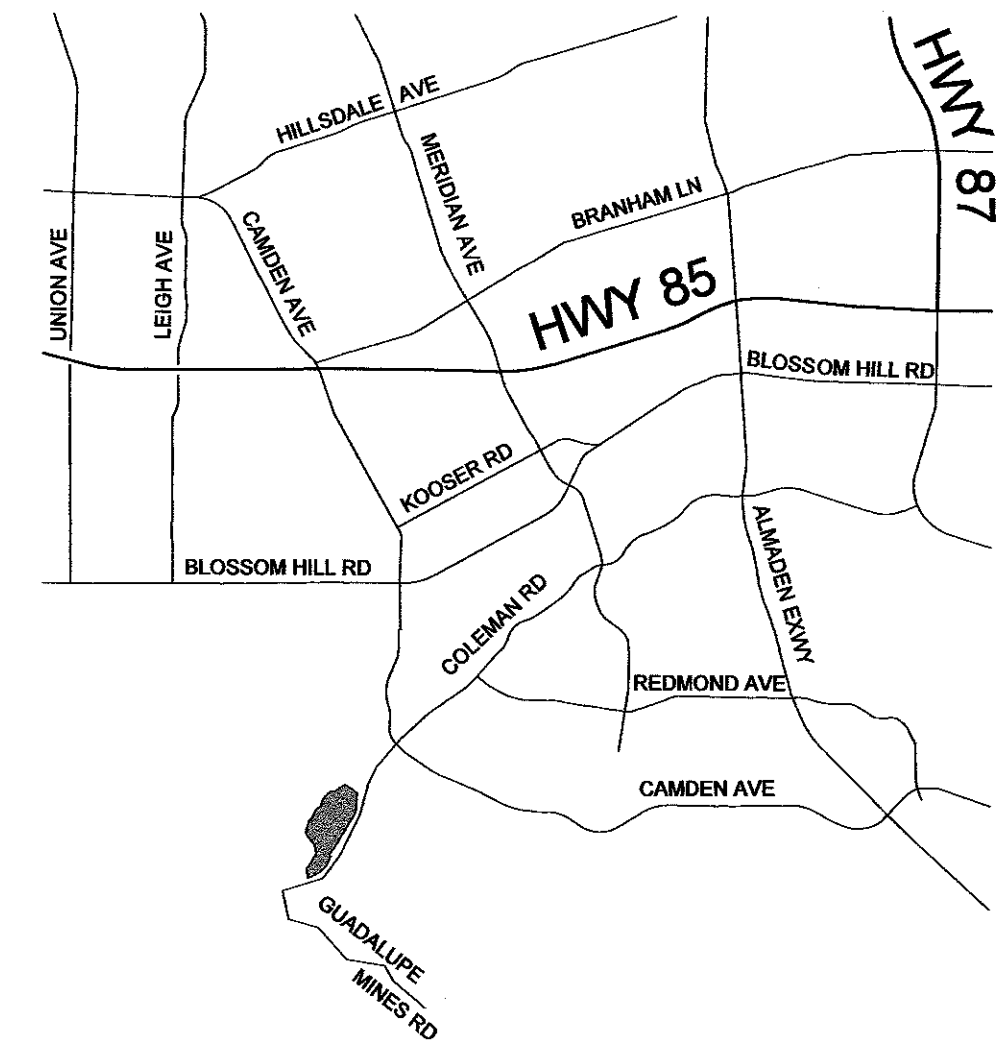

LOCATION MAP

LEGEND	
	DISTRICT BOUNDARY
	STREET RIGHT OF WAY
	PRIVATE STREET
	PROPERTY LINE
	REFERENCE NUMBER
	ASSESSOR'S PARCEL NUMBER (APN)

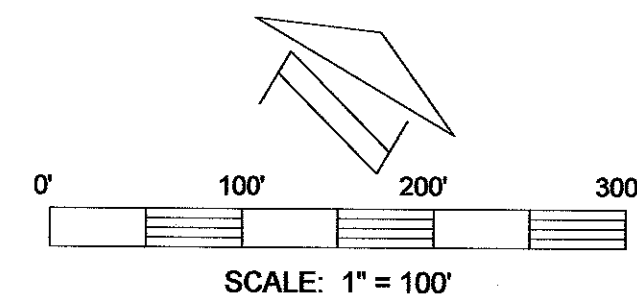

21851487

47
38
38

38