

APPENDIX B

Tree Survey

Little Portugal Gateway Mixed-Use Project Initial Study/MND

Kielty Arborist Services LLC

Certified Arborist WE#0476A

P.O. Box 6187

San Mateo, CA 94403

650- 515-9783

September 3, 2019

David J. Powers & Associates, Inc.

Attn: Amber Sharpe

1871 The Alameda, Suite 200

San Jose, CA 95126

Site: 1661-1665 Alum Rock Avenue, San Jose CA

Dear Ms. Sharpe,

As requested on Monday, July 29, 2019, I visited the above site for the purpose of inspecting and commenting on the trees. A mixed-use project is proposed on this site, prompting the need to remove all of the trees on site.

Method:

All inspections were made from the ground; the trees were not climbed for this inspection. The trees in question were located on tree summary plan L1.0. The trees were then measured for diameter at four and a half feet above grade. (DBH or diameter at breast height). The trees were given a condition rating for form and vitality. The trees' condition rating is based on 50 percent vitality and 50 percent form, using the following scale.

1	-	29	Very Poor
30	-	49	Poor
50	-	69	Fair
70	-	89	Good
90	-	100	Excellent

The height of the trees was measured using a Nikon Forestry 550 Hypsometer. The spreads were paced off. Comments and recommendations for future maintenance are provided.

Survey key:

DBH-Diameter at breast height (4.5' above grade)

CON-Condition rating

HT/SP-Tree height and canopy spread

1661-1665 Alum Rock 9/3/19

(2)

Survey:

Tree#	Species	DBH	CON	HT/SP	Comments
1	Loquat (<i>Eriobotrya japonica</i>)	8.0	60	20/12	Fair vigor, fair form.
2	Plum (<i>Prunus sp.</i>)	6.0	30	15/10	Poor vigor, fair form, in decline.
3	Privet (<i>Ligustrum japonicum</i>)	6"x6	55	25/20	Fair vigor, poor form, multi leader at grade. Ordinance size tree
4	English walnut (<i>Juglans regia</i>)	8.0	60	20/15	Fair vigor, fair form, surrounded by hardscape.
5	Tree of heaven (<i>Ailanthus altissima</i>)	8.5	30	30/15	Fair vigor, poor form, decay on trunk, invasive.
6	Tree of heaven (<i>Ailanthus altissima</i>)	8"x3	30	30/20	Fair vigor, poor form, stump re-sprout, invasive. Ordinance size tree
7	Tree of heaven (<i>Ailanthus altissima</i>)	6-6	40	30/15	Fair vigor, poor form, codominant at grade, invasive. Ordinance size tree
8	Tree of heaven (<i>Ailanthus altissima</i>)	6.0	40	30/15	Fair vigor, poor form, suppressed, invasive.
9	Tree of heaven (<i>Ailanthus altissima</i>)	8.0	40	25/20	Fair vigor, poor form, invasive.
10	Tree of heaven (<i>Ailanthus altissima</i>)	8.0	40	25/20	Fair vigor, poor form, invasive.
11	Tree of heaven (<i>Ailanthus altissima</i>)	8.0	40	25/20	Fair vigor, poor form, invasive.
12	Tree of heaven (<i>Ailanthus altissima</i>)	6.0	40	25/20	Fair vigor, poor form, invasive.
13	Tree of heaven (<i>Ailanthus altissima</i>)	6.0	40	25/20	Fair vigor, poor form, invasive.
14	Tree of heaven (<i>Ailanthus altissima</i>)	14.0	40	25/20	Fair vigor, poor form, invasive. Ordinance size tree

1661-1665 Alum Rock 9/3/19

(3)

Survey:

Tree#	Species	DBH	CON	HT/SP	Comments
15	Tree of heaven (<i>Ailanthus altissima</i>)	6.0	40	25/20	Fair vigor, poor form, invasive.
16	Tree of heaven (<i>Ailanthus altissima</i>)	6.0	40	25/20	Fair vigor, poor form, invasive.
17	Coast live oak (<i>Quercus agrifolia</i>)	18.0	60	40/40	Good vigor, fair form, multi leader at 5 feet with poor unions, young tree. Ordinance size tree
18	Coast live oak (<i>Quercus agrifolia</i>)	4.5	40	10/10	Poor vigor, poor form, suppressed, topped in past.
19	Plum (<i>Prunus sp.</i>)	6"x3	0	10/10	DEAD. Ordinance size tree
20	Tree of heaven (<i>Ailanthus altissima</i>)	6.0	40	25/15	Fair vigor, poor form, invasive.
21	Tree of heaven (<i>Ailanthus altissima</i>)	8.0	40	35/20	Fair vigor, poor form, invasive.
22	Tree of heaven (<i>Ailanthus altissima</i>)	10.0	40	35/25	Fair vigor, poor form, invasive.
23	Red oak (<i>Quercus rubrum</i>)	2.0	80	12/5	Good vigor, good form, recently planted street tree.
24-39	Italian cypress (<i>Cupressus sempervirens</i>)	6.0	45	6/2	Fair vigor, poor form, topped to form hedge.



Summary:

The majority of the trees on site are in poor condition due to no maintenance or poor maintenance. Many invasive tree of heaven trees (*Ailanthus altissima*) were located on the site. This species is extremely invasive and encouraged for removal by most municipalities (including San Jose). Coast live oak trees #17 and #18 were the only native trees found on site. Because this is a multifamily/commercial lot a permit is required to remove a tree of any size. A tree removal permit is required if the tree is ordinance-size. A permit adjustment is required if the tree is smaller than ordinance size. My count shows 6 trees measuring greater than 12 inches in diameter (ordinance size). Tree #23 is a street tree that will also need a permit to be removed.

Showing Ailanthus trees (tree of heaven) at property line.

The information included in this report is believed to be true and based on sound arboricultural principles and practices.

Sincerely,

Kevin R. Kielty

Certified Arborist WE#0476A

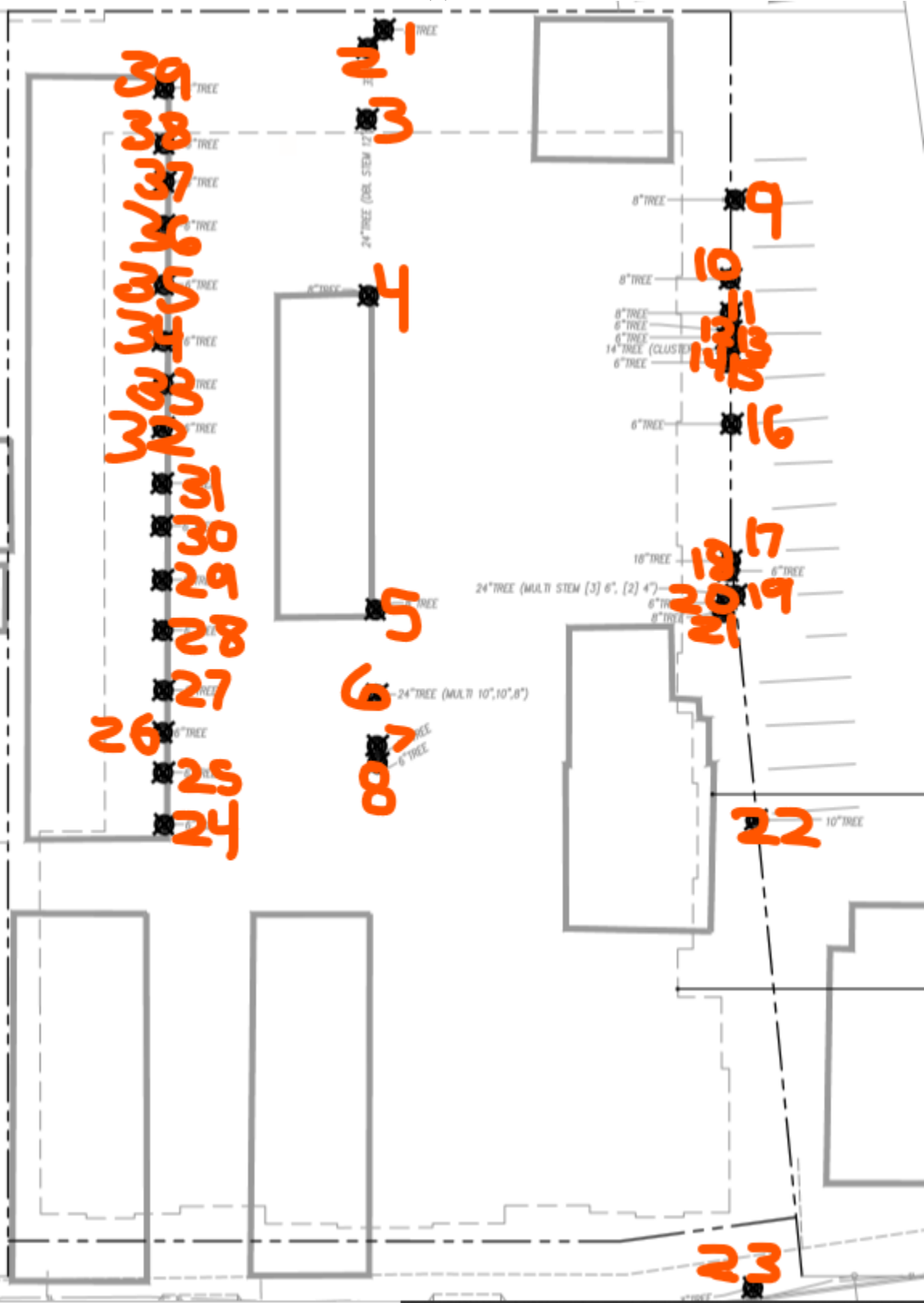

Showing tree number locations

Kielty Arborist Services

P.O. Box 6187
San Mateo, CA 94403
650-515-9783

ARBORIST DISCLOSURE STATEMENT

Arborists are tree specialists who use their education, knowledge, training and experience to examine trees, recommend measures to enhance the beauty and health of trees, and attempt to reduce the risk of living near trees. Clients may choose to accept or disregard the recommendations of the arborist, or seek additional advice.

Arborists cannot detect every condition that could possibly lead to the structural failure of a tree. Trees are living organisms that fail in ways we do not fully understand. Conditions are often hidden within trees and below ground. Arborists cannot guarantee that a tree will be healthy or safe under all circumstances, or for a specified period of time. Likewise, remedial treatments, like a medicine, cannot be guaranteed.

Treatment, pruning, and removal of trees may involve considerations beyond the scope of the arborist's services such as property boundaries, property ownership, site lines, disputes between neighbors, landlord-tenant matters, etc. Arborists cannot take such issues into account unless complete and accurate information is given to the arborist. The person hiring the arborist accepts full responsibility for authorizing the recommended treatment or remedial measures.

Trees can be managed, but they cannot be controlled. To live near a tree is to accept some degree of risk. The only way to eliminate all risks is to eliminate all trees.

Arborist: _____
Kevin R. Kielty

Date: September 3, 2019